

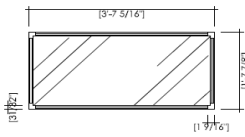

TYPE A1

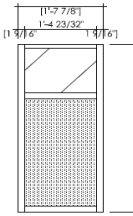

Lockable door
Glass front and 2 sides
Internal dimensions W 18.62" x L 42.04" x H 12.20"
1 LED Strip (7000 Kelvin)

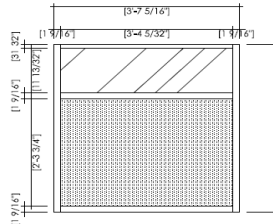

TYPE A2

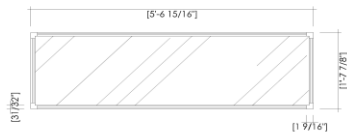

Lockable door
Glass front and 2 sides
Internal dimensions W 18.62" x L 65.66" x H 12.20"
1 LED Strip (7000 Kelvin)

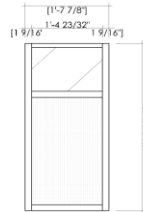
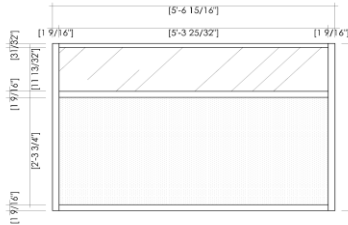

TYPE A3

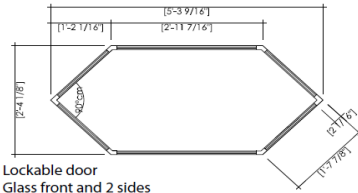

Lockable door
Glass front and 2 sides
Internal dimensions W 26.69" x L 61.02" x H 12.20"
1 LED Strip (7000 Kelvin)

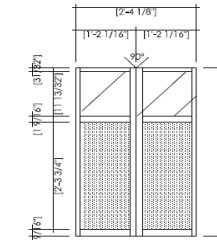
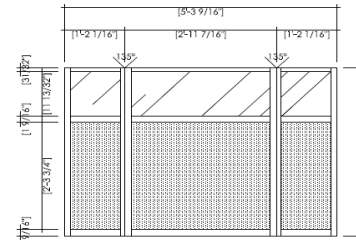

TYPE A1F

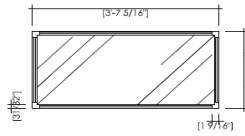

1 shelf
Glass 4 sides
Internal dimensions W 18.62" x L 42.04" x H 37.00"
1 LED Strip (7000 Kelvin)

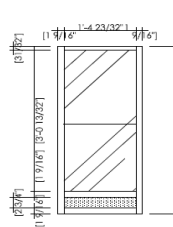
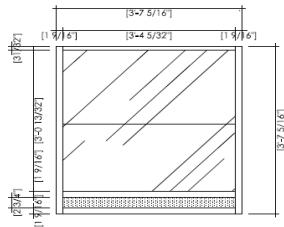

TYPE B1

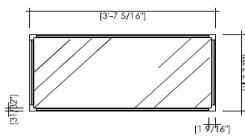

Lockable door
Glass front and 2 sides
Internal dimensions W 18.62" x L 42.04" x H 18.50"
3 LED bulbs (7000 Kelvin)

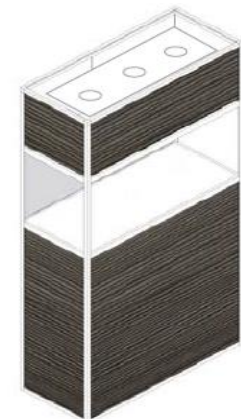
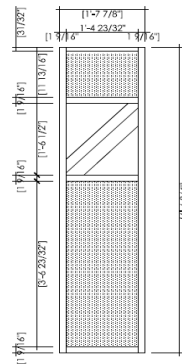
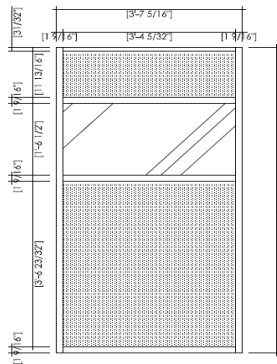



TYPE B2

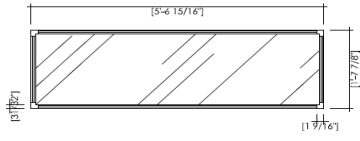

Lockable door
Glass front and 2 sides
Internal dimensions W 18.62" x L 65.66" x H 18.50"
4 LED bulbs (7000 Kelvin)

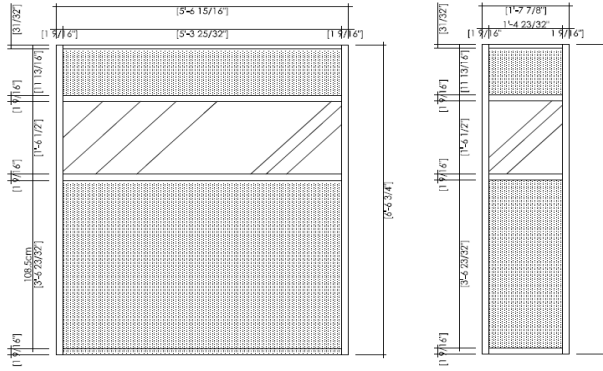

TYPE B3

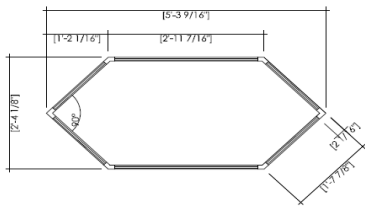

Lockable door
Glass front and 2 sides
Internal dimensions W 26.69" x L 61.02" x H 18.50"
3 LED bulbs (7000 Kelvin)

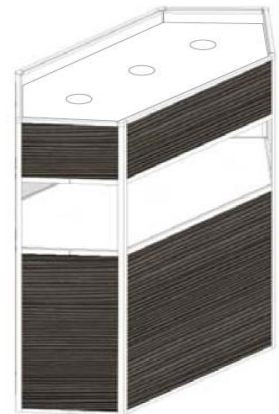
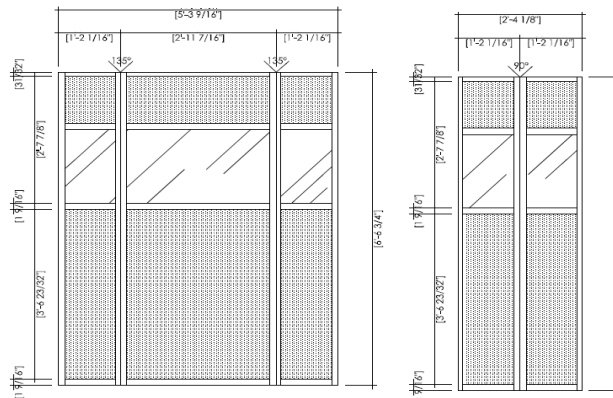

TYPE B1F

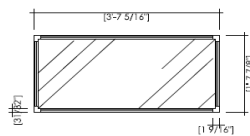

3 shelves
Glass 4 sides
Internal dimensions W 18.62" x L 42.04" x H 66.92"
3 LED bulbs (7000 Kelvin)

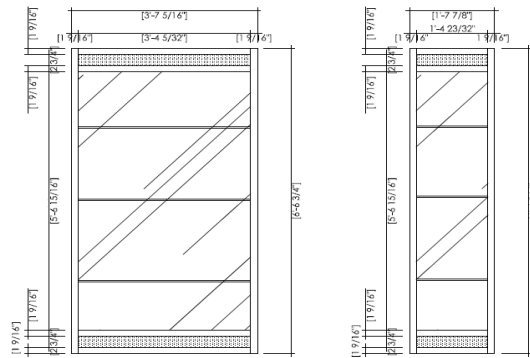

TYPE C1

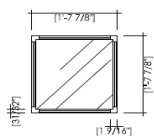

Lockable door
Glass front and 2 sides
Internal dimensions W 18.62" x L 18.62" x H 18.50"
1 LED bulb (7000 Kelvin)

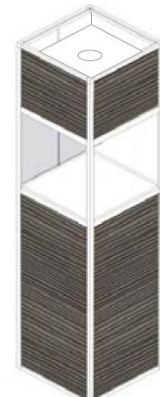
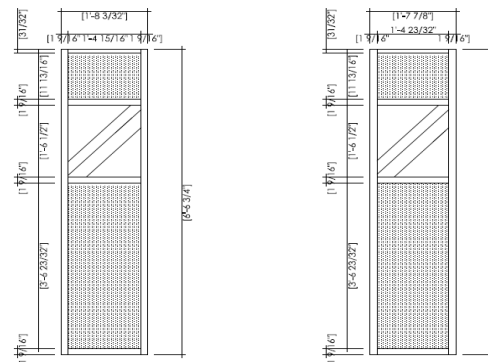



FB INTERNATIONAL, INC.

1 Raritan Road - Oakland, NJ 07436 - Ph. +1 201 337 1985 - Fax +1 201 337 4848
 services@fbinternational.net - www.fbinternational.com

Showcases Order Form

TYPE C1F

3 shelves
 Glass front and 2 sides
 Internal dimensions W 18.62" x L 18.62" x H 66.92"
 1 LED bulb (7000 Kelvin)

Company Name : _____ Booth # : _____

Contact Person : _____ Phone # : _____

Showcases (all the showcases included LED light inside)		Quantity	Advance rate	Regular rate	Amount
All LOW showcases included LED strip 7000 Kelvin	Type A1		\$400.00	\$500.00	
	Type A2		\$550.00	\$687.50	
	Type A3		\$550.00	\$687.50	
	Type A1F		\$400.00	\$500.00	
All TALL showcases included LED strip 7000 Kelvin	Type B1		\$580.00	\$725.00	
	Type B2		\$800.00	\$1,000.00	
	Type B3		\$800.00	\$1,000.00	
	Type B1F		\$800.00	\$1,000.00	
	Type C1		\$600.00	\$750.00	
Type C1F		\$600.00	\$750.00		
Light inside the showcases		Quantity	Advance rate	Regular rate	Amount
LED strip 39.9"L (7000 Kelvin)			\$80.00	\$104.00	
LED bulb (7000 Kelvin)			\$120.00	\$150.00	
Light above the showcases		Quantity	Advance rate	Regular rate	Amount
Track w/ 2 metal halide (HQI) light fixture - 140W			\$350.00	\$455.00	
Additional metal halide (HQI) light fixture (to be order in addition to track light fixture)			\$110.00	\$143.00	
Track w/ 2 halogen light fixture - 150W			\$210.00	\$273.00	
Additional halogen light fixture (to be order in addition to track light fixture)			\$80.00	\$104.00	
Track w/ 2 LED light fixture - 4500 Kelvin			\$210.00	\$273.00	
Additional LED light fixture - 4500 Kelvin (to be order in addition to track light fixture)			\$80.00	\$104.00	

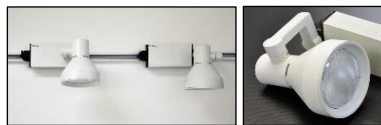

Track w/ 2 metal halide light

Additional metal halide light



Track w/ halogen light

Additional halogen light



Track w/ 2 LED light 4500 Kelvin

Additional LED light 4500 Kelvin

Sub total - Showcase :
Sub total - Light :
Grand Total :

Authorized Signature _____

Order form must be accompanied by METHOD OF PAYMENT FORM form processing
 Order deadline date March 30, 2018. Metric measurements available by contact.
 Email: services@fbinternational.net // Phone: +1 201 337 1985